

DESCRIPTION	EXISTING	PROPOSED
WATER MAIN - DRINKING WATER	ExNDW	DW
WATER MAIN - NON-DRINKING WATER	ExNDW	NDW
WATER CONDUIT	W	W
UNDERGROUND ELECTRICITY	ExE	E
OVERHEAD ELECTRICITY & POLE	ExOE	OE
TELECOMMUNICATIONS & SERVICE PIT	ExT	T
BRANCH SEWER & MANHOLE	ExS	S
SEWER & MANHOLE	ExS	S
COUNCIL STORMWATER DRAIN, PIT & HOUSE DRAIN/PROPERTY INLET		
SWALE / CUT OFF DRAIN		
LOW FLOW STORMWATER IRRIGATION PIPE		
STORMWATER DRAINAGE PIT NUMBER	01	01
CONCRETE VEHICLE CROSSING		
CONCRETE FOOTPATH		
RIDGE / CHANGE OF GRADE LINE		
SURFACE LEVEL	43.21	FS44.33
RIDGE LEVEL		FR43.55
FALL OF DESIGN SURFACE		
100 YEAR OVERLAND FLOW PATH		
PERMANENT SURVEY MARK		
TEMPORARY BENCH MARK		
BOLLARD		
ROAD CHAINAGES	CH36.20 (L/R)TP CH36.20	CH36.20 (L/R)TP CH36.20
LOT CHAINAGE	CH28.50	CH28.50
LIMIT OF WORKS		
SIGN AND POST		
BATTER		
TREE PROTECTION ZONE		
FENCE - OTHER		
FENCE - RESERVE		
VEGETATION LINE TO BE REMOVED		

NOTE:
REFER TO DWG No. 3002-04-011 FOR THE TYPICAL SWALE SECTION & INTERFACE WITH ADJACENT FUTURE STAGES

FOR CONTINUATION REFER TO SHEET 3002-04-101

SERVICES OFFSET TABLE

STREET NAME	NON-DRINKING WATER		DRINKING WATER		TELCO		ELECTRICITY		SEWER		TREE (BOK)	
	SIDE	OFFSET	SIDE	OFFSET	SIDE	OFFSET	SIDE	OFFSET	SIDE	OFFSET	SIDE	OFFSET
TIRAMISU ROAD	E	2.55	E	3.05	W	1.90	W	2.60	-	-	E & W	1.25
BAGUETTE ROAD	W	2.55	W	3.05	E	1.90	E	2.60	-	-	E & W	1.25
FRITTATA STREET	W	2.55	W	3.05	E	1.90	E	2.60	-	-	E & W	1.25
FUTURE ROAD A	S	2.10	S	2.60	N	1.90	N	2.60	-	-	N & S	1.25
FUTURE ROAD B	S	2.10	S	2.60	N	1.90	N	2.60	-	-	N & S	1.25
FUTURE ROAD C	S	2.10	S	2.60	N	1.90	N	2.60	-	-	N & S	1.25

1. TELCO AND ELECTRICITY CABLES TO BE CONSTRUCTED IN A COMMON TRENCH IN ACCORDANCE WITH ELECTRICAL AUTHORITY STANDARD DRAWINGS.
2. STREET LIGHTING TO BE 1.00m FROM BOK ON ELECTRICAL SIDE, UNLESS THERE IS A MEDIAN (WHERE IT WILL BE CENTRED)

NOTE:
FENCING BETWEEN LOTS AND RESERVES 1, 2 & 3 TO BE INSTALLED AS PER WHITTLESEA CITY COUNCIL STANDARD SDL.2.24



WARNING
BEWARE OF UNDERGROUND/OVERHEAD SERVICES
THE LOCATION OF SERVICES ARE APPROXIMATE ONLY AND THEIR EXACT POSITION SHOULD BE PROVEN ON SITE. NO GUARANTEE IS GIVEN THAT ALL EXISTING SERVICES ARE SHOWN. SPECIAL CONSIDERATION SHOULD BE GIVEN TO CONSTRUCTION PROCEDURES UNDER OVERHEAD ELECTRICITY TRANSMISSION LINES.

REV	DATE	DRN	CKD	APP	AMENDMENT
3	06.08.25	NT			DRAIN PIT 36A ADDED
2	30.07.25	NT	FP	K. LORRIMAR	12EP, 14EP & 39EP WITH CONSTRUCTION NOTES ADDED
1	18.07.25	NT	FP	K. LORRIMAR	WESTERN SIDE ON TIRAMISU ROAD REVISED
0	09.05.25	AWT	FP	K. LORRIMAR	ISSUED FOR CONSTRUCTION

ISSUED FOR CONSTRUCTION

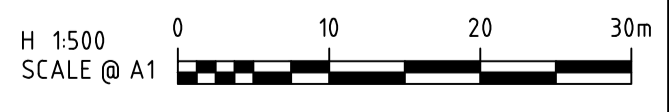

COPYRIGHT
The concepts and information contained in this document are the Copyright of Cossill & Webley Consulting Engineers. Use or copying of the document in whole or part without the written permission of Cossill & Webley Consulting Engineers constitutes an infringement of copyright.

Cossill & Webley
CONSULTING ENGINEERS

Street Address
Level 20, 350 St Kilda Road W cossillwebley.com.au
Melbourne VIC 3004 T (03) 8548 1560
E Melbourne.Reception@cosweb.com.au

SATTERLEY

APPROVED: PE 0005927
Klon

DESIGNED
R. GAUTAM
SCALE
1:500 @ A1

PROJECT
HEARTFORD ESTATE, DONNYBROOK - STAGE 04

TITLE
LAYOUT PLAN (SHEET 1 OF 2)

MUNICIPALITY
CITY OF WHITTLESEA

PP No.
PLN-38512

DRAWING No.
3002-04-100

REVISION
3

ORIGINAL SIZE
A1

C:\Users\klorr\OneDrive\Desktop\3002-04-100\PLN\DWG\8/16/2025\12:04 PM\HWA.A_TABL10.MXD

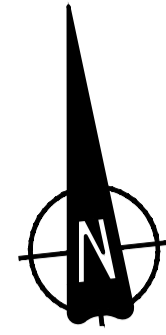

FOR CONTINUATION REFER TO SHEET 3002-04-100

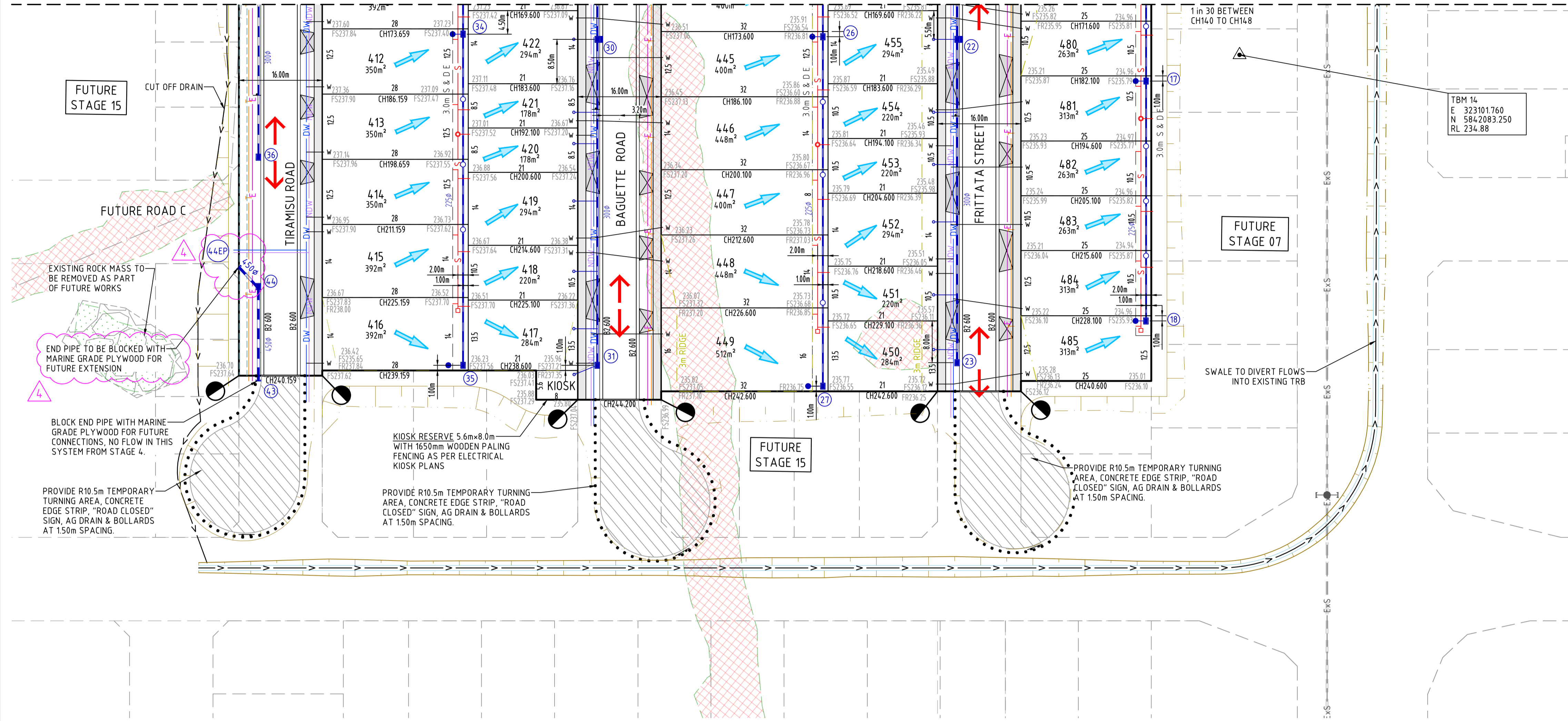

DESCRIPTION	EXISTING	PROPOSED
WATER MAIN - DRINKING WATER	ExNDW	DW
WATER MAIN - NON-DRINKING WATER	ExNDW	NDW
WATER CONDUIT	W	W
UNDERGROUND ELECTRICITY	ExE	E
OVERHEAD ELECTRICITY & POLE	ExOE	OE
TELECOMMUNICATIONS & SERVICE PIT	ExT	T
BRANCH SEWER & MANHOLE	ExS	S
SEWER & MANHOLE	ExS	S
COUNCIL STORMWATER DRAIN, PIT & HOUSE DRAIN/PROPERTY INLET		
SWALE / CUT OFF DRAIN		
LOW FLOW STORMWATER IRRIGATION PIPE		
STORMWATER DRAINAGE PIT NUMBER	01	01
CONCRETE VEHICLE CROSSING		
CONCRETE FOOTPATH		
RIDGE / CHANGE OF GRADE LINE		
SURFACE LEVEL	43.21	FS44.33
RIDGE LEVEL		FR43.55
FALL OF DESIGN SURFACE		
100 YEAR OVERLAND FLOW PATH		
PERMANENT SURVEY MARK		
TEMPORARY BENCH MARK		
BOLLARD		
ROAD CHAINAGES	CH36.20 (L/R)TP CH36.20	CH36.20 (L/R)TP CH36.20
LOT CHAINAGE	CH28.50	CH28.50
LIMIT OF WORKS		
SIGN AND POST		
BATTER		
TREE PROTECTION ZONE		
FENCE - OTHER		
VEGETATION LINE TO BE REMOVED		

NOTE:
REFER TO DWG No. 3002-04-011 FOR THE TYPICAL SWALE SECTION & INTERFACE WITH ADJACENT FUTURE STAGES

SERVICES OFFSET TABLE

STREET NAME	NON-DRINKING WATER		DRINKING WATER		TELCO		ELECTRICITY		SEWER		TREE (BOK)	
	SIDE	OFFSET	SIDE	OFFSET	SIDE	OFFSET	SIDE	OFFSET	SIDE	OFFSET	SIDE	OFFSET
TIRAMISU ROAD	E	2.55	E	3.05	W	1.90	W	2.60	-	-	E & W	1.25
BAGUETTE ROAD	W	2.55	W	3.05	E	1.90	E	2.60	-	-	E & W	1.25
FRITTATA STREET	W	2.55	W	3.05	E	1.90	E	2.60	-	-	E & W	1.25
FUTURE ROAD A	S	2.10	S	2.60	N	1.90	N	2.60	-	-	N & S	1.25
FUTURE ROAD B	S	2.10	S	2.60	N	1.90	N	2.60	-	-	N & S	1.25
FUTURE ROAD C	S	2.10	S	2.60	N	1.90	N	2.60	-	-	N & S	1.25

1. TELCO AND ELECTRICITY CABLES TO BE CONSTRUCTED IN A COMMON TRENCH IN ACCORDANCE WITH ELECTRICAL AUTHORITY STANDARD DRAWINGS.
2. STREET LIGHTING TO BE 1.00m FROM BOK ON ELECTRICAL SIDE, UNLESS THERE IS A MEDIAN (WHERE IT WILL BE CENTRED)



WARNING
BEWARE OF UNDERGROUND/OVERHEAD SERVICES
THE LOCATION OF SERVICES ARE APPROXIMATE ONLY AND THEIR EXACT POSITION SHOULD BE PROVEN ON SITE. NO GUARANTEE IS GIVEN THAT ALL EXISTING SERVICES ARE SHOWN. SPECIAL CONSIDERATION SHOULD BE GIVEN TO CONSTRUCTION PROCEDURES UNDER OVERHEAD ELECTRICITY TRANSMISSION LINES.

REV	DATE	DRN	CKD	APP	AMENDMENT
4	30.07.25	NT			44EP WITH CONSTRUCTION NOTES ADDED
3	22.07.25	RG	FP	K. LORRIMAR	WATER EXTENDED PAST LIMIT OF WORKS & TEMPORARY TURN AROUND UPDATED
2	18.07.25	NT	FP	K. LORRIMAR	WESTERN SIDE ON TIRAMISU ROAD REVISED & LEVELS FROM LOTS 414 - 416 UPDATED
1	09.07.25	RG	FP	K. LORRIMAR	PIT 31 MOVED
0	09.05.25	AWT	FP	K. LORRIMAR	ISSUED FOR CONSTRUCTION

ISSUED FOR CONSTRUCTION

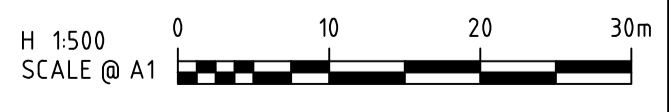

COPYRIGHT
The concepts and information contained in this document are the Copyright of Cossill & Webley Consulting Engineers. Use or copying of the document in whole or part without the written permission of Cossill & Webley Consulting Engineers constitutes an infringement of copyright.
This plan is not to be used for construction unless issued as revision 0 or higher

CW Cossill & Webley
CONSULTING ENGINEERS
Street Address
Level 20, 390 St Kilda Road W cossill@webley.com.au
Melbourne VIC 3004 T (03) 8548 1560
E Melbourne.Reception@cosweb.com.au

CLIENT
SATTERLEY
APPROVED: PE 0005927
DESIGNED
R. GAUTAM
SCALE
1:500 @ A1

PROJECT
HEARTFORD ESTATE, DONNYBROOK - STAGE 04
TITLE
LAYOUT PLAN (SHEET 2 OF 2)
MUNICIPALITY
CITY OF WHITTLESEA
PP No.
PLN-38512
DRAWING No.
3002-04-101
REVISION
4

ORIGINAL SIZE
A1

C:\3002\441\3002-04-101\Design\441\3002-04-101_Plan.dwg 7/20/2025 10:10 PM RAJAN GAUTAM

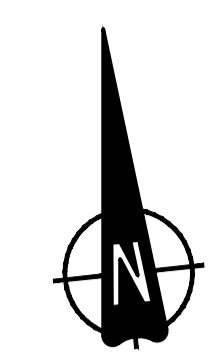
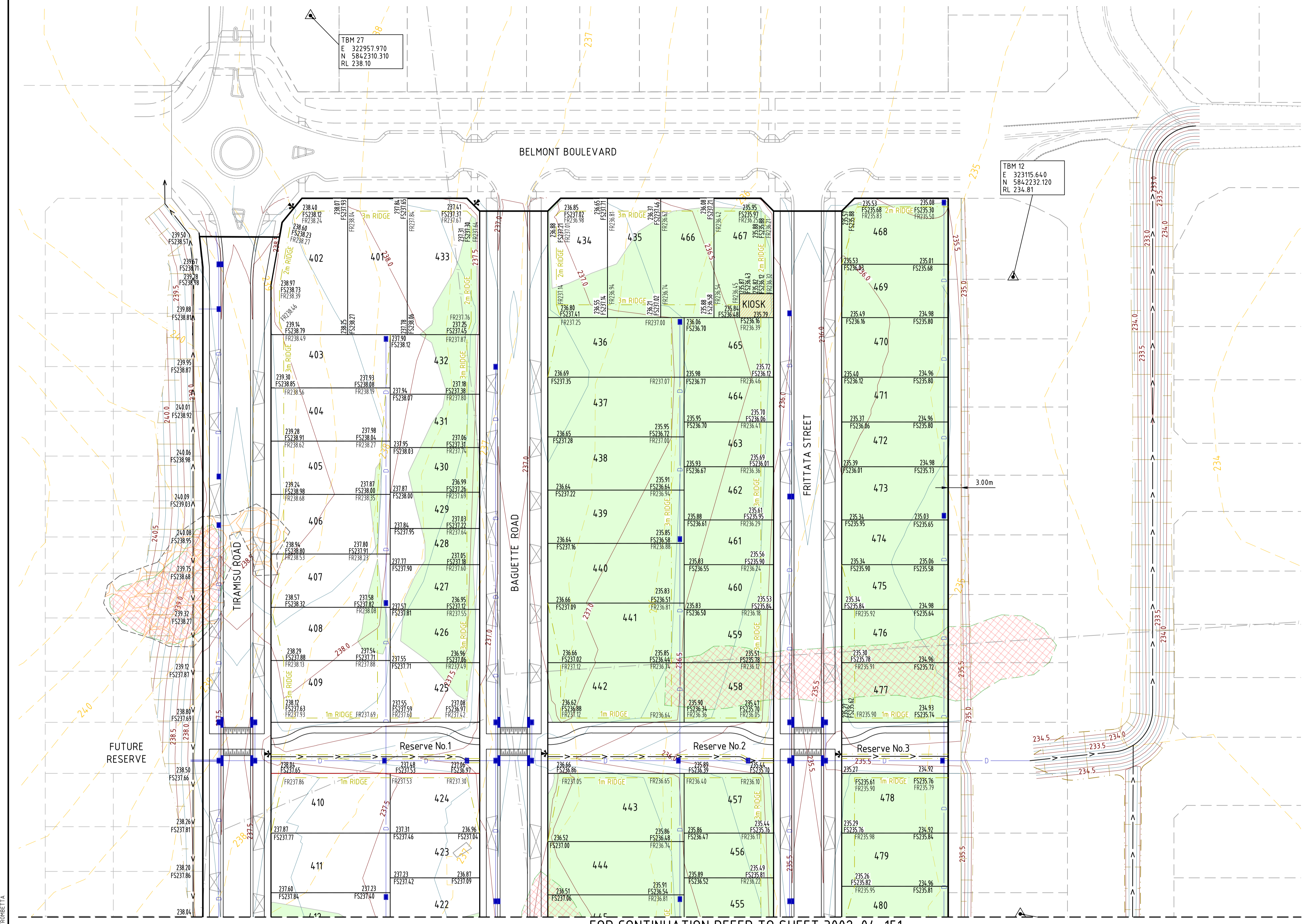

LEGEND		
DESCRIPTION	EXISTING	PROPOSED
SWALE / CUT OFF DRAIN		
SURFACE CONTOUR MAJOR - 500mm INTERVALS		
SURFACE CONTOUR MINOR - 250mm INTERVALS		
FINISHED SURFACE LEVEL	43.21	FS44.33
RIDGE LEVEL		R4.3.55
RIDGE / CHANGE OF GRADE LINE		
COUNCIL STORMWATER DRAIN & PIT		
PERMANENT SURVEY MARK		
TEMPORARY BENCH MARK		
BATTER		
FENCE - OTHER		
VEGETATION LINE TO BE REMOVED		
ELECTRICAL KIOSK		
FILLING GREATER THAN 300mm		

NOTE:
REFER TO DWG No. 3002-04-011 FOR THE TYPICAL INTERFACE WITH ADJACENT FUTURE STAGE

FOR CONTINUATION REFER TO SHEET 3002-04-151



WARNING
BEWARE OF UNDERGROUND/OVERHEAD SERVICES
THE LOCATION OF SERVICES ARE APPROXIMATE ONLY AND THEIR EXACT POSITION SHOULD BE PROVEN ON SITE. NO GUARANTEE IS GIVEN THAT ALL EXISTING SERVICES ARE SHOWN. SPECIAL CONSIDERATION SHOULD BE GIVEN TO CONSTRUCTION PROCEDURES UNDER OVERHEAD ELECTRICITY TRANSMISSION LINES.

C:\Users\alexa\Documents\3002-04-151\DWG\3002-04-151.dwg 5/9/2023 3:09 PM ALEX FROMBETTA

REV	DATE	DRN	CKD	APP	AMENDMENT
0	09.05.25	AWT			ISSUED FOR CONSTRUCTION

ISSUED FOR CONSTRUCTION

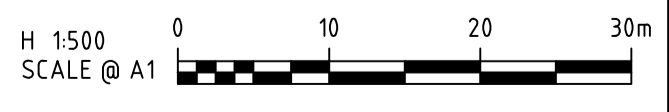

COPYRIGHT
The concepts and information contained in this document are the Copyright of Cossill & Webley Consulting Engineers. Use or copying of the document in whole or part without the written permission of Cossill & Webley Consulting Engineers constitutes an infringement of copyright.
This plan is not to be used for construction unless issued as revision 0 or higher

CW Cossill & Webley CONSULTING ENGINEERS
Street Address
Level 20, 350 St Kilda Road W cossillwebley.com.au
Melbourne VIC 3004 T (03) 8548 1560
E Melbourne.Reception@cosweb.com.au

SATTERLEY
APPROVED PE 0005927
DESIGNED R. GAUTAM
SCALE 1:500

PROJECT	HEARTFORD ESTATE, DONNYBROOK - STAGE 04		
TITLE	EARTHWORKS PLAN (SHEET 1 OF 2)		
MUNICIPALITY	CITY OF WHITTLESEA		
PP No.	PLN-38512	DRAWING No.	3002-04-150
REVISION			0

ORIGINAL SIZE A1

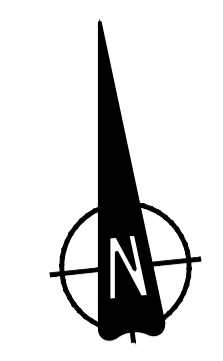

FOR CONTINUATION REFER TO SHEET 3002-04-150

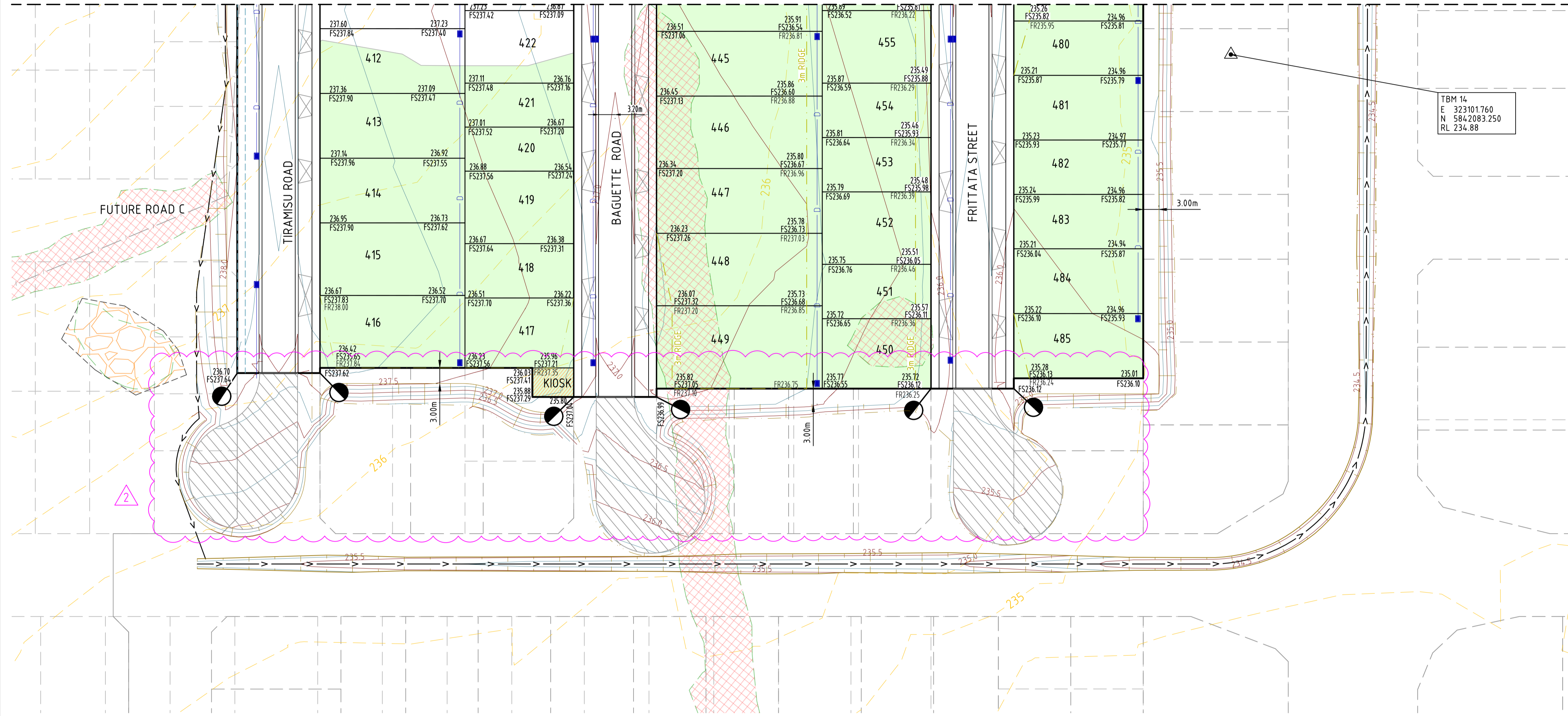

TBM 14
E 323101.760
N 5842083.250
RL 234.88

LEGEND		
DESCRIPTION	EXISTING	PROPOSED
SWALE / CUT OFF DRAIN		
SURFACE CONTOUR MAJOR - 500mm INTERVAL		
SURFACE CONTOUR MINOR - 250mm INTERVAL		
FINISHED SURFACE LEVEL	43.21	FS44.33
RIDGE LEVEL		R4.3.55
RIDGE / CHANGE OF GRADE LINE		
PERMANENT SURVEY MARK		
TEMPORARY BENCH MARK		
BATTER		
FENCE - OTHER		
VEGETATION LINE TO BE REMOVED		
ELECTRICAL KIOSK		
FILLING GREATER THAN 300mm		

NOTE:
REFER TO DWG No. 3002-04-011 FOR THE TYPICAL INTERFACE WITH ADJACENT FUTURE STAGE



WARNING
BEWARE OF UNDERGROUND/OVERHEAD SERVICES
THE LOCATION OF SERVICES ARE APPROXIMATE ONLY AND THEIR EXACT POSITION SHOULD BE PROVEN ON SITE. NO GUARANTEE IS GIVEN THAT ALL EXISTING SERVICES ARE SHOWN. SPECIAL CONSIDERATION SHOULD BE GIVEN TO CONSTRUCTION PROCEDURES UNDER OVERHEAD ELECTRICITY TRANSMISSION LINES.

REV	DATE	DRN	CKD	APP	AMENDMENT
2	22.07.25	NT			DESIGN CONTOURS & BATTERS UPDATED
1	18.07.25	NT	FP	K. LORRIMAR	LOT LEVELS AND DESIGN CONTOURS UPDATED
0	09.05.25	AWT	FP	K. LORRIMAR	ISSUED FOR CONSTRUCTION

ISSUED FOR CONSTRUCTION

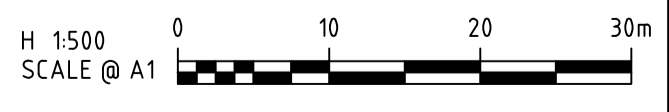

COPYRIGHT
The concepts and information contained in this document are the Copyright of Cossill & Webley Consulting Engineers. Use or copying of the document in whole or part without the written permission of Cossill & Webley Consulting Engineers constitutes an infringement of copyright.
This plan is not to be used for construction unless issued as revision 0 or higher

CW Cossill & Webley
CONSULTING ENGINEERS
Street Address
Level 20, 390 St Kilda Road W cossillwebley.com.au
Melbourne VIC 3004 T (03) 8548 1560
E Melbourne.Reception@cosweb.com.au

SATTERLEY
APPROVED PE 0005927
DESIGNED
R. GAUTAM
SCALE
1:500 @ A1

PROJECT
HEARTFORD ESTATE, DONNYBROOK - STAGE 04
TITLE
EARTHWORKS PLAN (SHEET 2 OF 2)
MUNICIPALITY
CITY OF WHITTLESEA
PP No.
PLN-38512
DRAWING No.
3002-04-151
REVISION
2

ORIGINAL SIZE A1

C:\3002-04\151\3002-04-151.dwg 7/22/2025 10:28 PM RAJAN GAUTAM