

EXCAVATION GREATER THAN 0.20m	
FILLING GREATER THAN 0.20m	
BATTER	
EXISTING SURFACE LEVEL	E123.45
FINISHED SURFACE LEVEL	F124.68
TOP OF BATTER LEVEL	T124.80
LOT GRADE	1 in 150

NOTES:

1. DEPTHS OF CUT AND FILL AS MEASURED BETWEEN EXISTING AND FINISHED SURFACES.
2. BATTER MAXIMUM IN FRONT OF LOT 4 METRES
3. BATTER MAXIMUM TO SIDE OF LOT 2 METRES

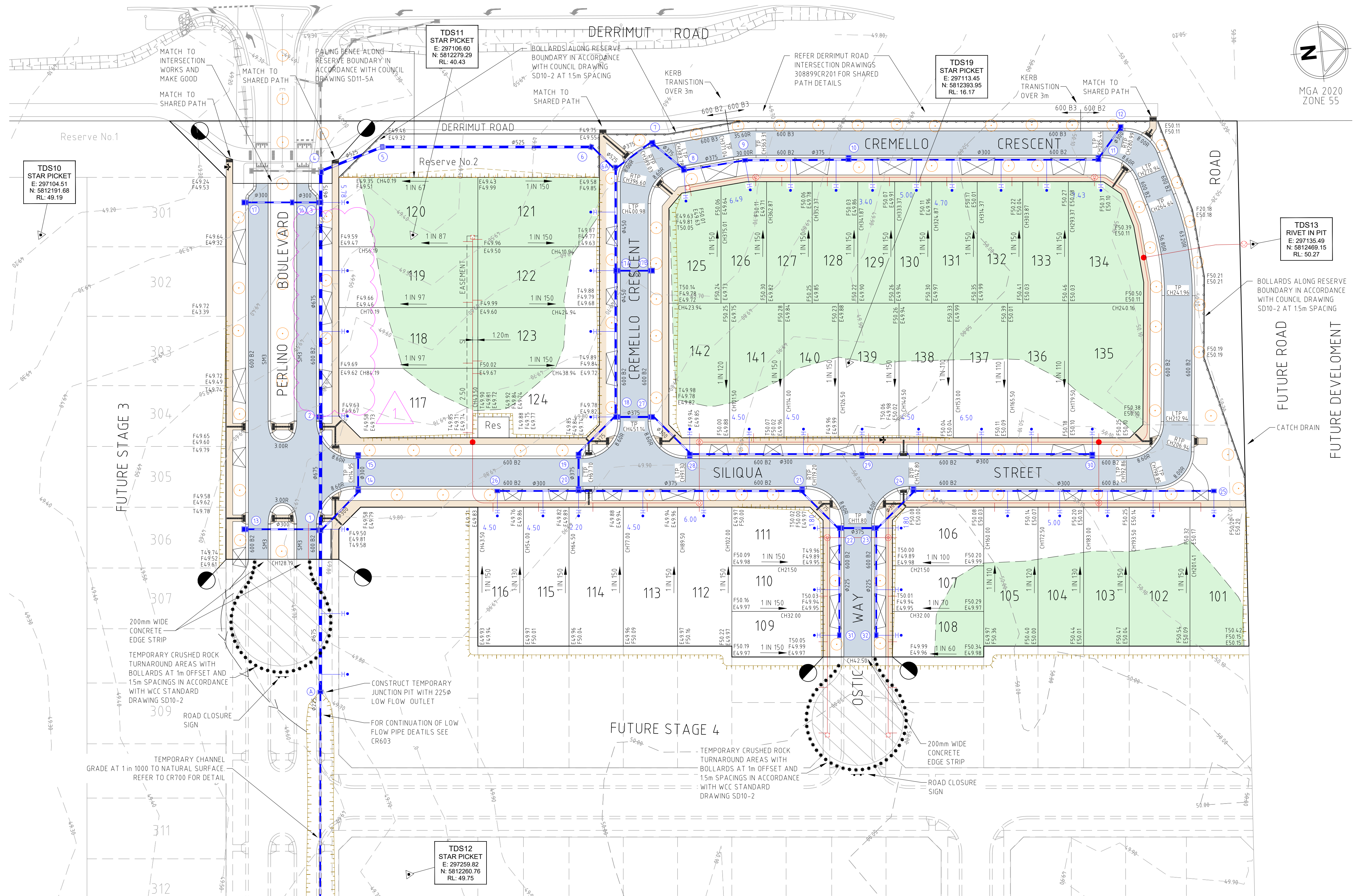

WARNING
BEWARE OF UNDERGROUND/OVERHEAD SERVICES
THE LOCATION OF SERVICES ARE APPROXIMATE ONLY AND THEIR EXACT POSITION SHOULD BE PROVEN ON SITE. NO GUARANTEE IS GIVEN THAT ALL EXISTING SERVICES ARE SHOWN. SPECIAL CONSIDERATION SHOULD BE GIVEN TO CONSTRUCTION PROCEDURES UNDER OVERHEAD ELECTRICITY TRANSMISSION LINES.

(1)	SERVICE OFFSET TABLE AND DRIVEWAY LOCATION AMENDED	MR	14/04/22
(0)	ISSUED FOR CONSTRUCTION	MR	04/04/22
(E)	COUNCIL COMMENTS	MR	11/03/22
(D)	COUNCIL COMMENTS	MR	22/02/22
(C)	ISSUED TO COUNCIL	MR	18/01/22
(B)	ADD DRAINAGE OUTFALL	MR	12/01/22
(A)	ISSUED FOR TENDER	BM	22/12/21
Rev	Amendments	Approved	Date



© Spiire Australia Pty Ltd All Rights Reserved
This document is produced by Spiire Australia Pty Ltd solely for the benefit of and use by the client in accordance with the terms of the retainer. Spiire Australia Pty Ltd does not and shall not assume any responsibility or liability whatsoever to any third party arising out of any use or reliance by third party on the content of this document.

spiire

L6 414 LA TROBE STREET PO BOX 16084 MELBOURNE
VICTORIA 8007 AUSTRALIA T 61 3 9993 7888
spiire.com.au ABN 55 050 029 635



Designed
GARY JORDAN
Authorised
MATT READMAN

Checked
JOHN KOEHLER
Date
01/22

**BLUESTONE TARNEIT
STAGE 1
ROAD AND DRAINAGE
ROAD LAYOUT PLANS - FACE PLAN
WYNDHAM CITY COUNCIL
SATTERLEY PROPERTY GROUP**

CONSTRUCTION	Drg No 308808CR200	Rev (1)
---------------------	------------------------------	-------------------

file name 308808\CR200.dwg, layout name CR200 plotted by Ali Khurshid
file location G:\30\308808\Civil\Acad plot date 12/05/2022 8:50 AM Sheet 2 of 19 Sheets

file name: 308808CR201.dwg, layout name: CR201, plotted by: Ali Khushfah, file location: \\spire\shared\Drawings\308808\308808.dwg, plot date: 12/05/2022 8:50 AM, Sheet: 3 of 19, Sheets

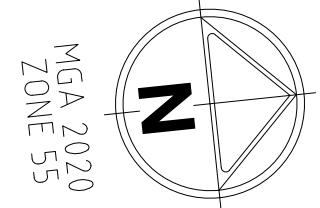
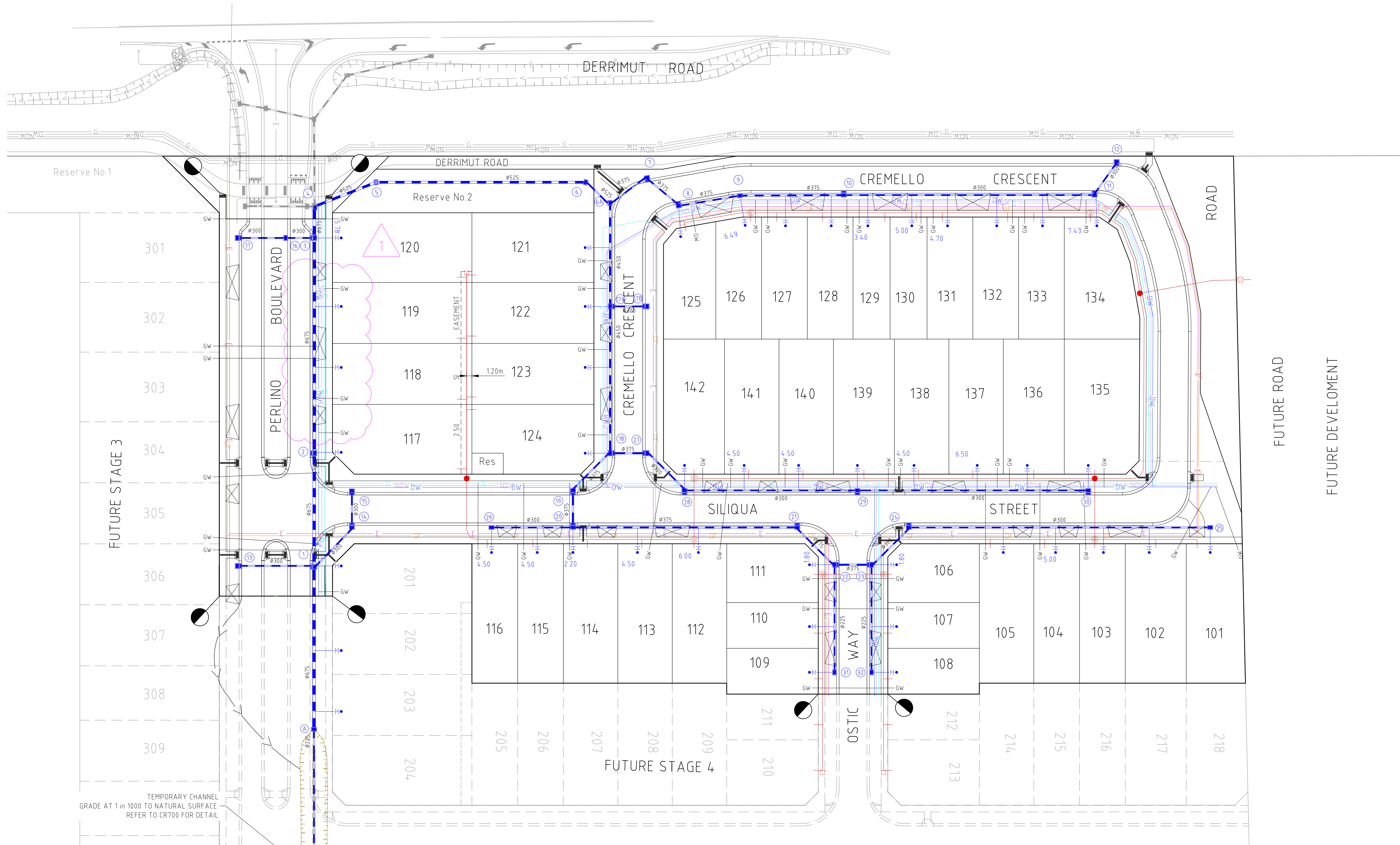

SERVICE LOCATION TABLE

ROAD NAME	SEWER		GAS		NON-DRINKING WATER		DRINKING WATER		NBN (TELECOM)		ELECTRICITY	
	SIDE	OFFSET	SIDE	OFFSET	SIDE	OFFSET	SIDE	OFFSET	SIDE	OFFSET	U/G CABLE	SIDE
PERLINO BOULEVARD	-	-	NORTH	1.80	NORTH	2.45	NORTH	3.20	SOUTH	1.85	SOUTH	2.35
SILQUA STREET (NORTH -SOUTH)	WEST	1.00	WEST	2.10	WEST	2.60	WEST	3.05	EAST	1.85	EAST	2.35
CREMELLO CRESCENT(LOTS 134-135)	SOUTH	1.00	SOUTH	2.10	SOUTH	2.60	SOUTH	3.05	NORTH	0.30	NORTH	0.60
CREMELLO CRESCENT (LOTS 125-134)	EAST	1.00	EAST	3.10	EAST	3.50	EAST	3.95	EAST	1.85	EAST	1.85
CREMELLO CRESCENT (LOTS 121-124)	SOUTH	1.00	SOUTH	2.10	SOUTH	2.60	SOUTH	3.05	NORTH	1.85	NORTH	2.35
OSTIC WAY	NORTH	1.00	NORTH	2.10	NORTH	2.60	NORTH	3.05	SOUTH	1.85	SOUTH	2.35

1. TELECOMMUNICATIONS AND ELECTRICITY CABLES TO BE CONSTRUCTED IN A COMMON TRENCH IN ACCORDANCE WITH ELECTRICITY AUTHORITY STANDARD DRG's.
2. GAS AND WATER MAINS TO BE CONSTRUCTED IN A COMMON TRENCH.



WARNING

BEWARE OF UNDERGROUND/OVERHEAD SERVICES
THE LOCATION OF SERVICES ARE APPROXIMATE ONLY. AND THEIR EXACT POSITION SHOULD BE PROVEN ON SITE. NO GUARANTEE IS GIVEN THAT ALL EXISTING SERVICES ARE SHOWN. SPECIAL CONSIDERATION SHOULD BE GIVEN TO CONSTRUCTION PROCEDURES UNDER OVERHEAD ELECTRICITY TRANSMISSION LINES.

Rev	Amendments	Approved	Date
(1)	SERVICE OFFSET TABLE AND DRIVEWAY LOCATION AMENDED	MR	14/04/22
(0)	ISSUED FOR CONSTRUCTION	MR	04/04/22
(C)	COUNCIL COMMENTS	MR	22/02/22
(B)	ISSUED TO COUNCIL	MR	18/01/22
(A)	ISSUED FOR TENDER	BM	22/12/21

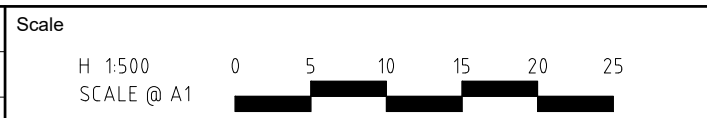

© Spiire Australia Pty Ltd All Rights Reserved
This document is produced by Spiire Australia Pty Ltd solely for the benefit of and use by the client in accordance with the terms of the retainer. Spiire Australia Pty Ltd does not and shall not assume any responsibility or liability whatsoever to any third party arising out of any use or reliance by third party on the content of this document.

spiire

L6 414 LA TROBE STREET PO BOX 16084 MELBOURNE
VICTORIA 8007 AUSTRALIA T 61 3 9993 7888
spiire.com.au ABN 55 050 029 635

Satterley

Designed
GARY JORDAN
Authorised
MATT READMAN

Checked
JOHN KOEHLER
Date
01/22

**BLUESTONE TARNEIT
STAGE 1
ROAD AND DRAINAGE
ROAD LAYOUT PLANS - SERVICES PLAN**
WYNDHAM CITY COUNCIL
SATTERLEY PROPERTY GROUP

CONSTRUCTION Drg No 308808CR201 Rev (1)