

EVERGREEN

AT BOTANICAL

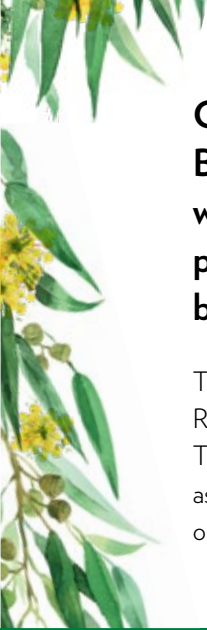

BERGAMOT
RELEASE
STAGE 13



**Come home to Evergreen,
Botanical's newest neighbourhood
where families will flourish in the
perfect balance of unspoilt natural
beauty and modern convenience.**

The Bergamot Release is located close to Mount Ridley Road, and the established Mickleham Primary School. There is a planned park within walking distance, as well as the stunning nearby nature reserve. Don't miss this opportunity to live in Botanical's newest neighbourhood.



Artist impression

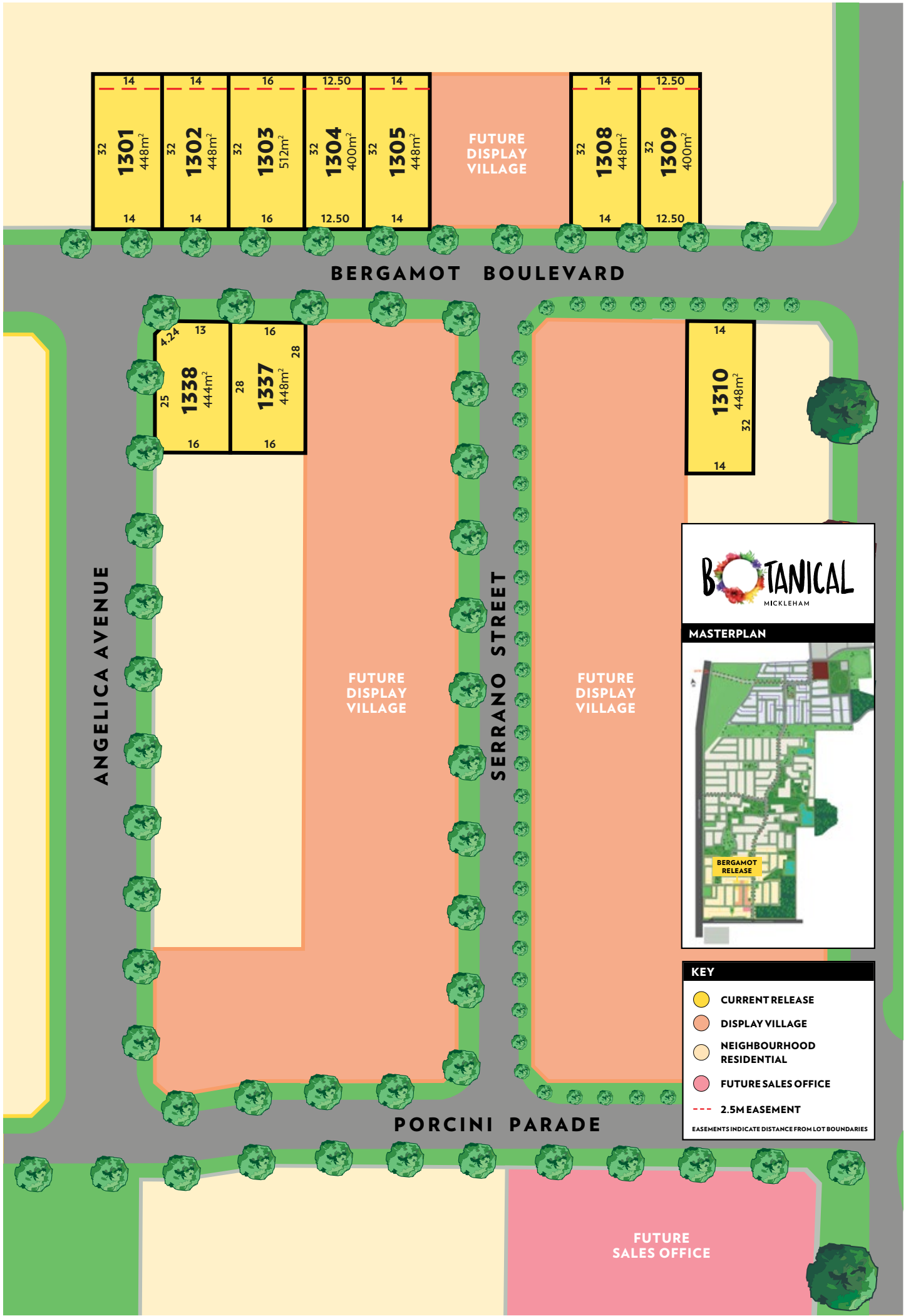

MASTERPLAN

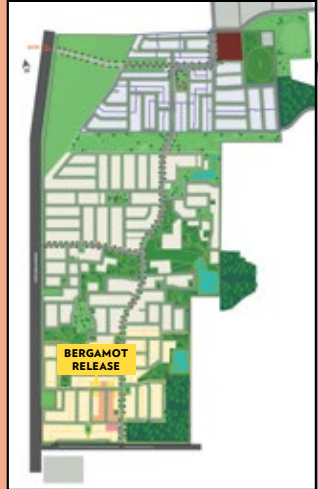

KEY

- CURRENT RELEASE
 - DISPLAY VILLAGE
 - NEIGHBOURHOOD RESIDENTIAL
 - FUTURE SALES OFFICE
 - 2.5M EASEMENT
- EASEMENTS INDICATE DISTANCE FROM LOT BOUNDARIES



With over 30 hectares of planned open space to enjoy, your family will have plenty of room in which to play, relax and grow at Botanical. At the heart of the community, you'll find a planned 22-hectare Botanical Park featuring wetlands, a playground and a breathtaking botanical garden, all just waiting to be explored. Add this to the fact that schools and shops are only a short drive away, and it's clear to see that Botanical is the perfect place to put down some roots.

BOTANICAL SALES AND INFORMATION CENTRE

Located at 34 Poppy Street (off Mickleham Road), Mickleham

Land Sales Centre is open 7 days

Monday: 1pm - 5pm, Tuesday - Sunday: 11am - 5pm

Phone: 1800 200 800



All dimensions and areas are subject to survey and subject to change. The particulars on this brochure are supplied for identification purposes only and shall not be taken as a representation in any aspect on the part of the vendor or its agents. Authorities should be consulted when services are contained within lot boundaries as building restrictions may apply. All retaining walls, services and associated easements are shown exaggerated for legibility. Trees are indicative only. All engineering is preliminary and subject to change without notice. ©Copyright. Printed March 2021. SAT8074