

SERVICES OFFSET TABLE												
STREET NAME	GAS		NON-DRINKING WATER		DRINKING WATER		TELCO		ELECTRICITY		SEWER	
	SIDE	OFFSET	SIDE	OFFSET	SIDE	OFFSET	SIDE	OFFSET	SIDE	OFFSET	SIDE	OFFSET
SWISS BOULEVARD (29.4m)	NONE		W	2.70	W	3.20	E	1.90	E	2.60	W	1.00
SWISS BOULEVARD (28.0m)	NONE		W	2.70	W	3.20	E	1.90	E	2.60	-	1.00
SWISS BOULEVARD (25.0m)	NONE		W	2.70	W	3.20	E	1.90	E	2.60	-	1.00
MUNSTER ROAD (20.0m)	NONE		N	2.60	N	3.10	S	1.90	S	2.60	N	1.00
FOCACCIA GROVER (20.0m)	NONE		S	2.60	S	3.10	N	1.90	N	2.60	-	1.00
MOZZARELLA WAY (16.0m)	NONE		W	2.55	W	3.05	E	1.90	E	2.60	W	1.00
CIABATTA WAY (16.0m)	NONE		N	2.55	N	3.05	S	1.90	S	2.60	N	1.00
CHEDDAR STREET (16.0m)	NONE		N	2.55	N	3.05	S	1.90	S	2.60	-	1.00
1. TELCO AND ELECTRICITY CABLES TO BE CONSTRUCTED IN A COMMON TRENCH IN ACCORDANCE WITH ELECTRICAL AUTHORITY STANDARD DRAWINGS. 2. GAS AND WATER MAINS TO BE CONSTRUCTED IN A COMMON TRENCH. 3. STREET LIGHTING TO BE 1.00m FROM BOK ON ELECTRICAL SIDE, UNLESS THERE IS A MEDIAN (WHERE IT WILL BE CENTRED)												

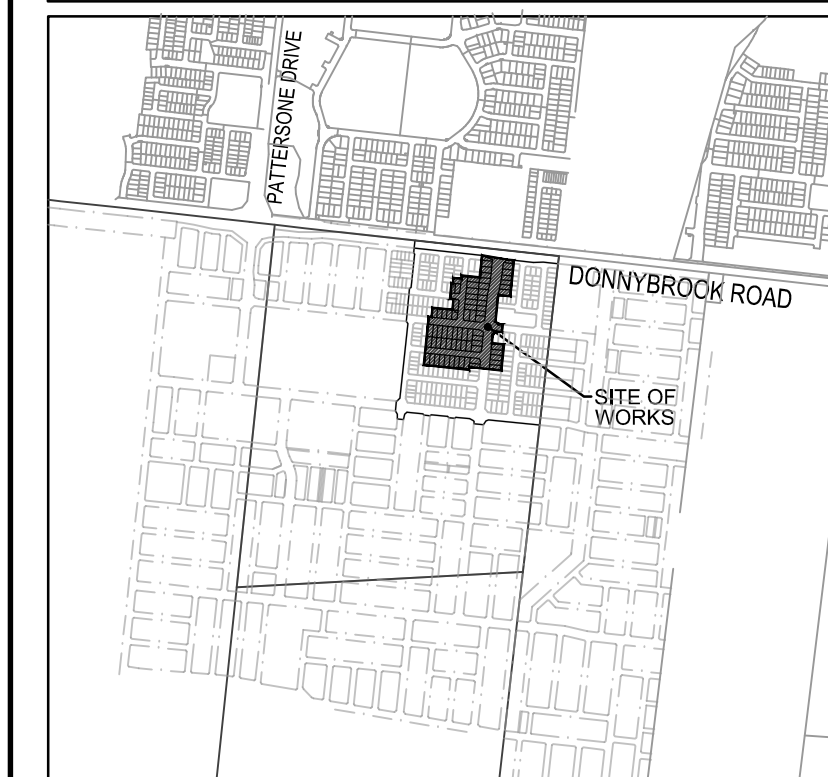

LOCALITY PLAN  
1:20,000

#### FENCE NOTE

- PROVIDE TIMBER PALING FENCE ALONG COMMON BOUNDARY OF A LOT AND COUNCIL RESERVE.
- REFER COUNCIL STANDARD DRAWING SDL 3.11 & SDL 3.12.
- PALINGS TO BE ON THE RESERVE SIDE.

#### CUTOFF DRAIN NOTE

- PROVIDE NOMINAL 300mm DEEP CUTOFF DRAIN / BUND TO DIRECT EXISTING SURFACE WATER RUNOFF TO PROPOSED ROAD (TYP)

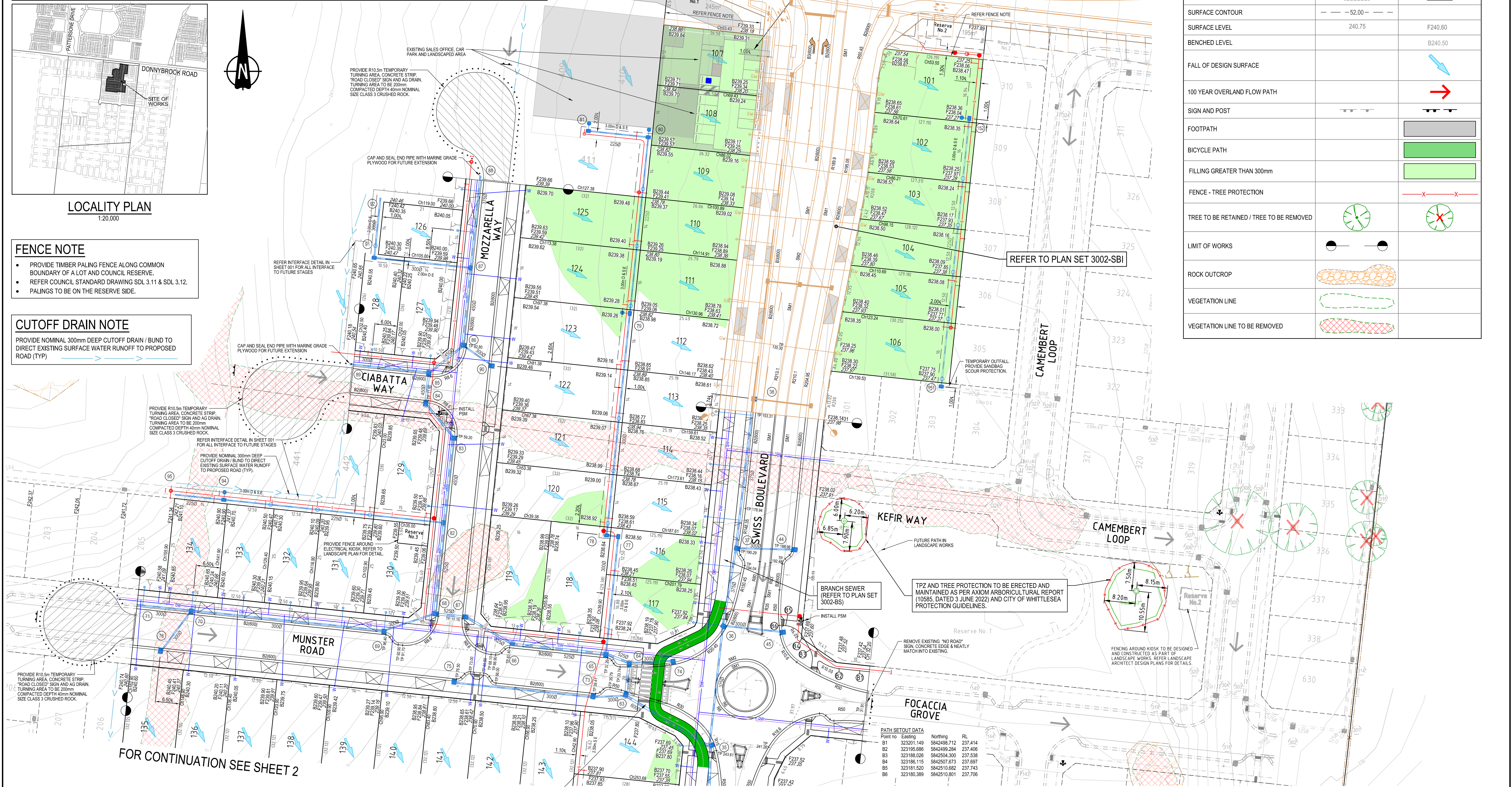

#### LEGEND

DESCRIPTION	EXISTING	PROPOSED
WATER MAIN - DRINKING WATER	— DW —	— DW —
WATER MAIN - NON-DRINKING WATER	— NDW —	— NDW —
WATER CONDUITS	— W —	— W —
UNDERGROUND ELECTRICITY	— E —	— E —
TELSTRA / COMMS	— C —	— C —
BRANCH SEWER & MANHOLE	— BS —	— BS —
SEWER & MANHOLE	— S —	— S —
CENTRAL INVERT	— I —	— I —
COUNCIL STORMWATER DRAIN, PIT & HOUSE DRAIN / PROPERTY INLET	— SD —	— SD —
CONCRETE VEHICLE CROSSING	— VC —	— VC —
SURFACE CONTOUR	— 52.00 —	— F240.60 —
SURFACE LEVEL	240.75	F240.50
BENCHED LEVEL		B240.50
FALL OF DESIGN SURFACE		— FS —
100 YEAR OVERLAND FLOW PATH		— OF —
SIGN AND POST		— SP —
FOOTPATH		— FP —
BICYCLE PATH		— BP —
FILLING GREATER THAN 300mm		— FG —
FENCE - TREE PROTECTION		— FT —
TREE TO BE RETAINED / TREE TO BE REMOVED	— TR —	— TR —
LIMIT OF WORKS	— LW —	— LW —
ROCK OUTCROP		— RO —
VEGETATION LINE		— VL —
VEGETATION LINE TO BE REMOVED		— VLR —

6	09.10.24	NT	KL	CHMP EXCLUSION ZONE REMOVED
5	03.09.24	TP	FP	PSM'S LABELED
4	30.05.24	EK	FP	SPLITTER ISLAND KERBS, FOOTPATH & SET OUT POINTS UPDATED AND NOTE ADDED
3	12.01.24	AP	FP	GAS REMOVED, CONDUITS SYMBOL UPDATED & PATH ALIGNMENT EAST OF ROUNDABOUT UPDATED
2	19.12.23	RG	FP	LOT 409, 410 DRAINAGE CONNECTIONS ADDED, TPZ DIMENSIONED & REVISION CLOUDS ADDED
REV	DATE	DRN	CKD	APP

RAISED CROSSINGS FOR PEDESTRIAN AND TWO-WAY BIKE PATHS ARE VARIATIONS ON THE VPA STANDARD FIGURE 001, 002 AND 003. VARIATIONS TO THE STANDARD DRAWINGS HAVE BEEN MADE AND ARE TO BE ASSESSED AND APPROVED BY COUNCIL.

FOR CONSTRUCTION

H: 1:500  
SCALE @ A1

0 10 20 30m

COPYRIGHT  
This document is the Copyright of Cossill & Webley Consulting Engineers. Use or copying of the document in whole or part without the written permission of Cossill & Webley Consulting Engineers constitutes an infringement of copyright.

This plan is not to be used for construction unless issued as revision 0 or higher

Mailing Address  
PO Box 33152  
Melbourne VIC 3004  
T (03) 8548 1560

Street Address  
Level 20, 390 St Kilda Road  
Melbourne VIC 3004  
E melbourne@cosew.com.au

CW Cossill & Webley CONSULTING ENGINEERS

PROJECT  
HEARTFORD ESTATE, DONNYBROOK - STAGE 1

TITLE  
LAYOUT PLAN  
SHEET 1 OF 2  
CITY OF WHITTLESEA

MUNICIPALITY  
PP No. PLN-38300

DRAWING No. 3002-01-110

REVISION  
6

ORIGINAL SIZE  
A1

CLIENT  
SATTERLEY

AUTHORISED: PE 0005927

DESIGNED  
DG

SCALE  
AS SHOWN



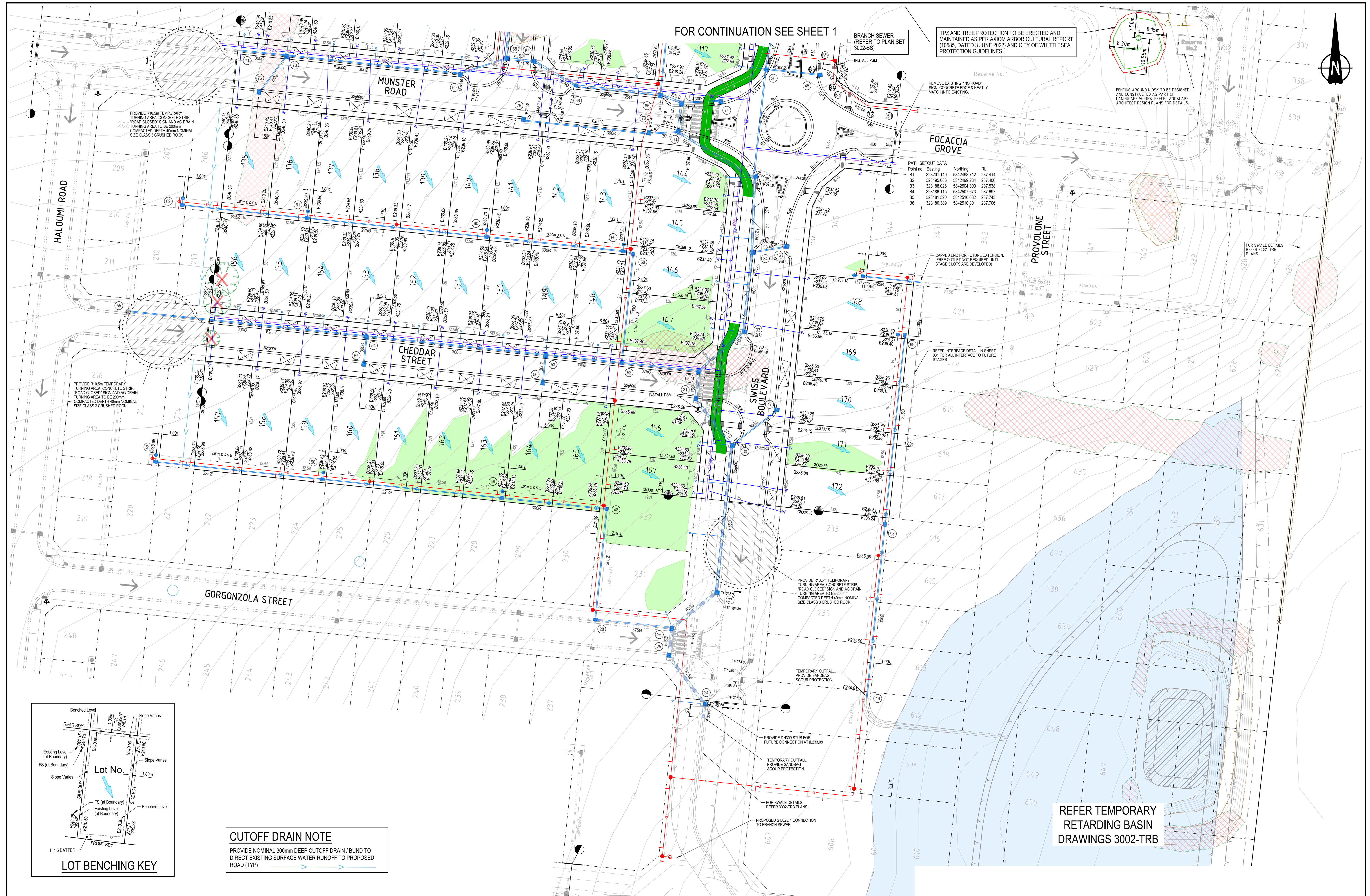

7	09.10.24	NT	<i>Am</i>	<i>Klan</i>	CHMP EXCLUSION ZONE REMOVED
6	03.09.24	TP	FP	KL	PSM'S LABELED
5	30.05.24	RG	FP	KL	SPLITTER ISLAND KERBS & FOOTPATH UPDATED AND NOTE ADDED
4	12.01.24	RG	FP	KL	WATER CONDUITS SYMBOL UPDATED AFTER GAS REMOVAL
REV	DATE	DRN	CKD	APP	AMENDMENT

FOR CONSTRUCTION

H: 1:500  
SCALE @ A1

0 10 20 30m

COPYRIGHT  
The concepts and information contained in this document are the Copyright of Cossill & Webley Consulting Engineers. Use or copying of the document in whole or part without the written permission of Cossill & Webley Consulting Engineers constitutes an infringement of copyright.

This plan is not to be used for construction unless issued as revision 0 or higher

Cossill & Webley  
CONSULTING ENGINEERS

Mailing Address  
PO Box 33152  
Melbourne VIC 3004  
T (03) 8548 1560

Street Address  
Level 20, 390 St Kilda Road  
Melbourne VIC 3004  
E melbourne@cosweb.com.au

CLIENT  
SATTERLEY

AUTHORISED: PE 0005927

DESIGNED  
DG

SCALE  
AS SHOWN

PROJECT  
HEARTFORD ESTATE, DONNYBROOK - STAGE 1

TITLE  
LAYOUT PLAN  
SHEET 2 OF 2  
CITY OF WHITTLESEA

MUNICIPALITY  
PP No.  
PLN-38300

DRAWING No.  
3002-01-111

REVISION  
7

ORIGINAL SIZE  
A1