

SERVICE OFFSET TABLE

Location	Gas		ND - Water		Water		Electricity		Telecommunication		Sewer	
	Side	Offset (m)	Side	Offset (m)	Side	Offset (m)	Side	Offset (m)	Side	Offset (m)	Side	Offset (m)
ROAD B	E	2.10	W	2.60	W	3.10	E	2.40	E	1.80	W	1.00
ROAD F	W	2.10	W	2.60	W	3.10	E	2.40	E	1.80	E / W	1.00
ROAD G	N	2.10	N	2.60	N	3.10	S	2.40	S	1.80	N / S	1.00
ROAD H	N	2.10	N	2.60	N	3.10	S	2.40	S	1.80	N / S	1.00
ROAD I	N	2.10	N	2.60	N	3.10	S	2.40	S	1.80	N	1.00

NOTE: STREET TREES ARE TO BE PLANTED IN THE CENTRE OF ALL NATURE STRIPS

ROAD LAYOUT TABLE

Road Name	Road Classification	Reserve Width (m)	Road Width (m)			Kerb Type		Verge Width (m)	
			Lip to Lip	Inv to Inv	Back to Back	Nth/West	Sth/East	Nth/West	Sth/East
ROAD B	COLLECTOR	20.00	9.70	10.60	10.90	600 B2	600 B2	4.85	4.55
ROAD F	LOCAL	16.00	6.40	7.30	7.60	600 B2	600 B2	4.50	4.20
ROAD G	LOCAL	16.00	6.40	7.30	7.60	600 B2	600 B2	4.50	4.20
ROAD H	LOCAL	16.00	6.40	7.30	7.60	600 B2	600 B2	4.50	4.20
ROAD I	LOCAL	16.00	6.40	7.30	7.60	600 B2	600 B2	4.50	4.20

LEGEND - MARKETING PLAN

- STORMWATER DRAIN, PIT & PROPERTY INLET
- MELBOURNE WATER DRAIN & PIT
- SWALE DRAIN
- SEWER & MAINTENANCE STRUCTURES
- HOUSE DRAIN
- SERVICE CONDUITS
- TACTILE PAVERS
- ELECTRICITY (UNDERGROUND)
- ELECTRICITY (OVERHEAD)
- OPTIC FIBRE
- TELECOMMUNICATIONS
- GAS
- WATER
- RECYCLED WATER
- EXISTING STORMWATER DRAIN
- EXISTING SEWER
- EXISTING HOUSE DRAIN
- EXISTING SWALE DRAIN
- ZERO LOT LINES
- RIDGE LINE
- DESIGN PADS
- DIRECTION OF FALL
- OVERLAND FLOW
- ALLOTMENT TO BE GRADED EVENLY IN
- DIRECTION OF FALL TO LEVELS INDICATED
- CONCRETE EDGE STRIP WITH SUBSOIL DRAIN
- "NO ROAD" SIGN & BARRIER
- PROPOSED DRIVEWAY
- EXISTING SURFACE LEVEL
- FINISHED BUILDING LINE LEVEL
- FINISHED RIDGE LINE LEVEL
- TOP OF RETAINING WALL
- BOTTOM OF RETAINING WALL
- PAD DESIGN LEVELS
- MASS ROCK RETAINING WALL
- CONCRETE SLEEPER RETAINING WALL
- STRUCTURAL FILL > 200mm DEEP
- LOT HATCHING
- PAVEMENT HATCHING
- NATURE STRIP HATCHING
- RESERVE HATCHING
- ELECTRICAL KIOSK HATCHING

WARNING
BWARE OF UNDERGROUND SERVICES

The locations of underground services are approximate only and their exact position should be proven on site.
No guarantee is given that all existing services are shown.
Locate all underground services before commencement of works

DIAL 1100 BEFORE YOU DIG

www.1100.com.au

PRELIMINARY PRINT
NOT FOR CONSTRUCTION

© COPYRIGHT All rights reserved Beveridge Williams & Co. Pty Ltd has granted a licence to the principle to use this document for its intended purpose. No unauthorised copying is permitted									
P2	AMENDED AS PER CLIENTS REQUEST	25.07.22	YS	NM					
P1	AMENDED AS PER CLIENTS REQUEST	22.07.22	YS	NM					
P0	ISSUED FOR INFORMATION	20.07.22	YS	NM					
REV	DESCRIPTION	DATE	DRN.	APP.	REV	DESCRIPTION	DATE	DRN.	APP.

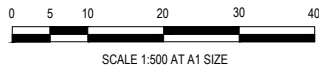

Designed	N.MARTENS
Date	01.01.2020
Drawn	L.SUTHERLAND
Approved	N.MARTENS
Date	20.07.22
PS Number	PS908410U

Beveridge Williams

1 Glenferrie Road
Malvern VIC 3144
ph: 03 9524 8888
www.beveridgewilliams.com.au

Project Details	10 CANTY LANE, PAKENHAM STAGE 02 CARDINIA SHIRE COUNCIL
Drawing Title	MARKETING PLAN (SHEET 1 OF 4)

Sheet 01 of 04			
Scale 1:500 @ A1			
Project Ref	Stage No	Drawing No	Rev
1701814	02	M01	P2

FOR CONTINUATION SEE SHEET 1701814-02-M02

FOR CONTINUATION SEE SHEET 1701814-02-M04

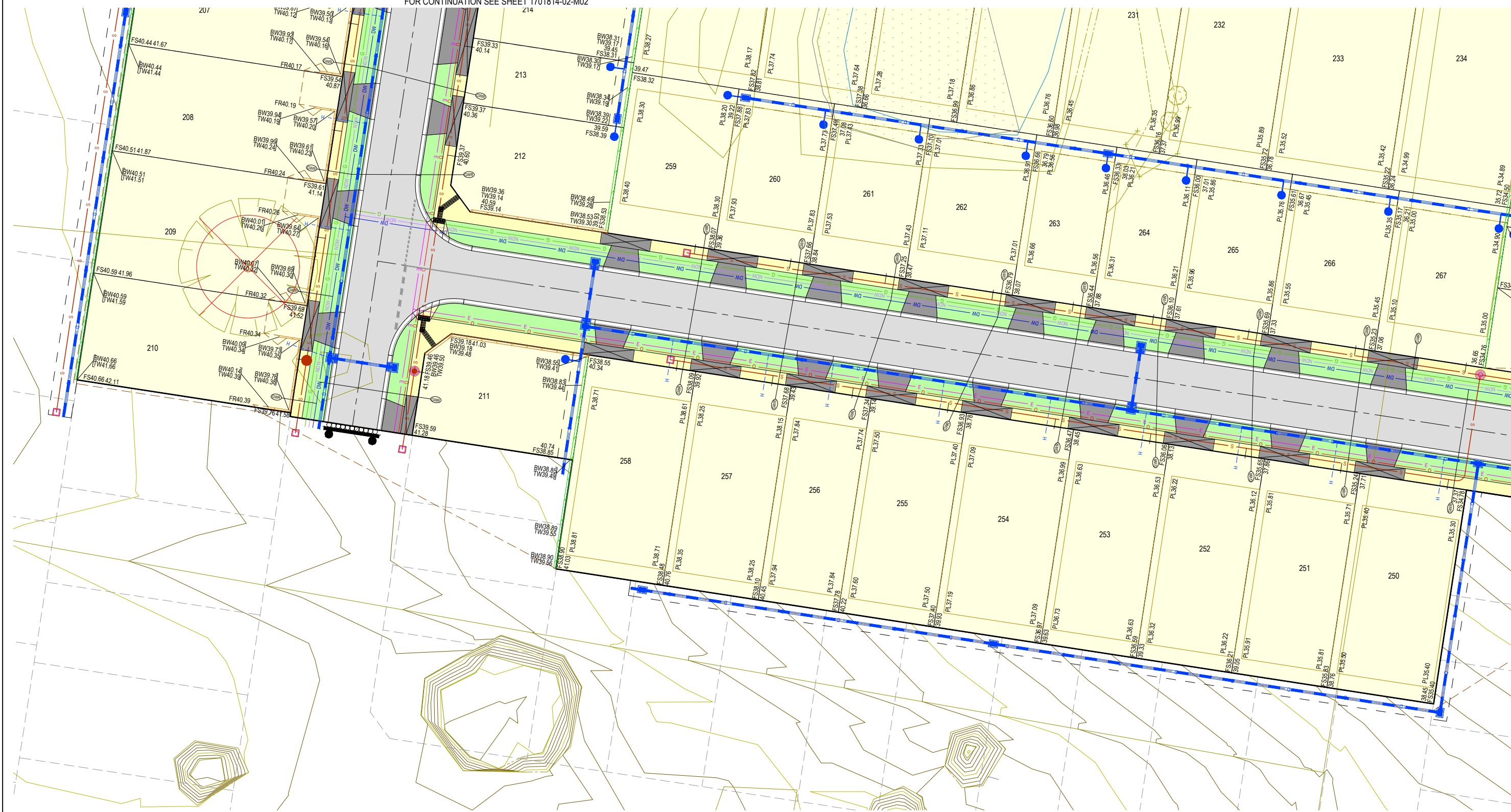

LEGEND - MARKETING PLAN

STORMWATER DRAIN, PIT & PROPERTY INLET	EXISTING STORMWATER DRAIN	141.34 EXISTING SURFACE LEVEL
MELBOURNE WATER DRAIN & PIT	EXISTING SEWER	FS140.35 FINISHED BUILDING LINE LEVEL
SWALE DRAIN	EXISTING HOUSE DRAIN	FR157.40 FINISHED RIDGE LINE LEVEL
SEWER & MAINTENANCE STRUCTURES	EXISTING SWALE DRAIN	TW159.30 TOP OF RETAINING WALL
HOUSE DRAIN	ZERO LOT LINES	BW159.30 BOTTOM OF RETAINING WALL
SERVICE CONDUITS	RIDGE LINE	PL159.30 PAD DESIGN LEVELS
TACTILE PAVERS	DESIGN PADS	MASS ROCK RETAINING WALL
ELECTRICITY (UNDERGROUND)	DIRECTION OF FALL	CONCRETE SLEEPER RETAINING WALL
ELECTRICITY (OVERHEAD)	OVERLAND FLOW	STRUCTURAL FILL > 200mm DEEP
OPTIC FIBRE	ALLOTMENT TO BE GRADED EVENLY IN	LOT HATCHING
TELECOMMUNICATIONS	DIRECTION OF FALL TO LEVELS INDICATED	PAVEMENT HATCHING
GAS	CONCRETE EDGE STRIP WITH SUBSOIL DRAIN	NATURE STRIP HATCHING
WATER	"NO ROAD" SIGN & BARRIER	RESERVE HATCHING
RECYCLED WATER	PROPOSED DRIVEWAY	ELECTRICAL KIOSK HATCHING

PRELIMINARY PRINT
NOT FOR CONSTRUCTION

© COPYRIGHT All rights reserved
Beveridge Williams & Co. Pty Ltd has granted a licence to the principle to use this document for its intended purpose.
No unauthorised copying is permitted

REV	DESCRIPTION	DATE	DRN.	APP.	REV	DESCRIPTION	DATE	DRN.	APP.
P2	AMENDED AS PER CLIENTS REQUEST	25.07.22	YS	NM					
P1	AMENDED AS PER CLIENTS REQUEST	22.07.22	YS	NM					
P0	ISSUED FOR INFORMATION	20.07.22	YS	NM					

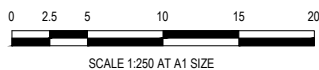

Designed
Date
N.MARTENS
01.01.2020
Drawn
L.SUTHERLAND
Approved
Date
N.MARTENS
20.07.22
PS Number
PS908410U

BW Beveridge Williams
1 Glenferrie Road
Malvern VIC 3144
ph: 03 9524 8888
www.beveridgewilliams.com.au

Project
Details
10 CANTY LANE, PAKENHAM
STAGE 02
CARDINIA SHIRE COUNCIL
Drawing
Title
MARKETING PLAN
(SHEET 3 OF 4)

Sheet 03 of 04

Scale
1:250 @ A1

Project Ref
1701814
Stage No
02
Drawing No
M03
Rev
P2

K:\Jobs Data\1701814 - 10 Canty Lane, Pakenham_Eng\Stage 2\Drawings\1701814-02-M.dwg

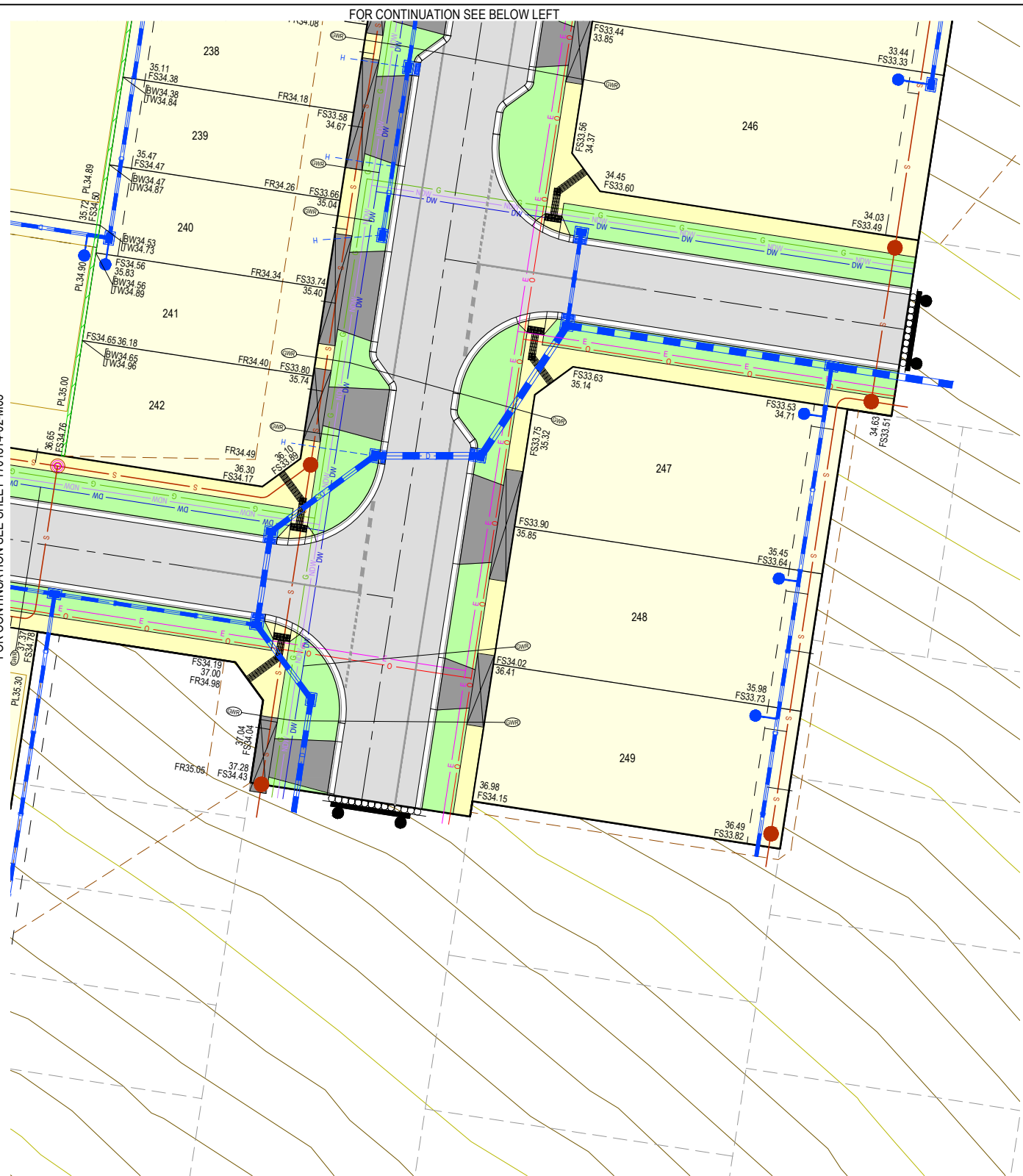
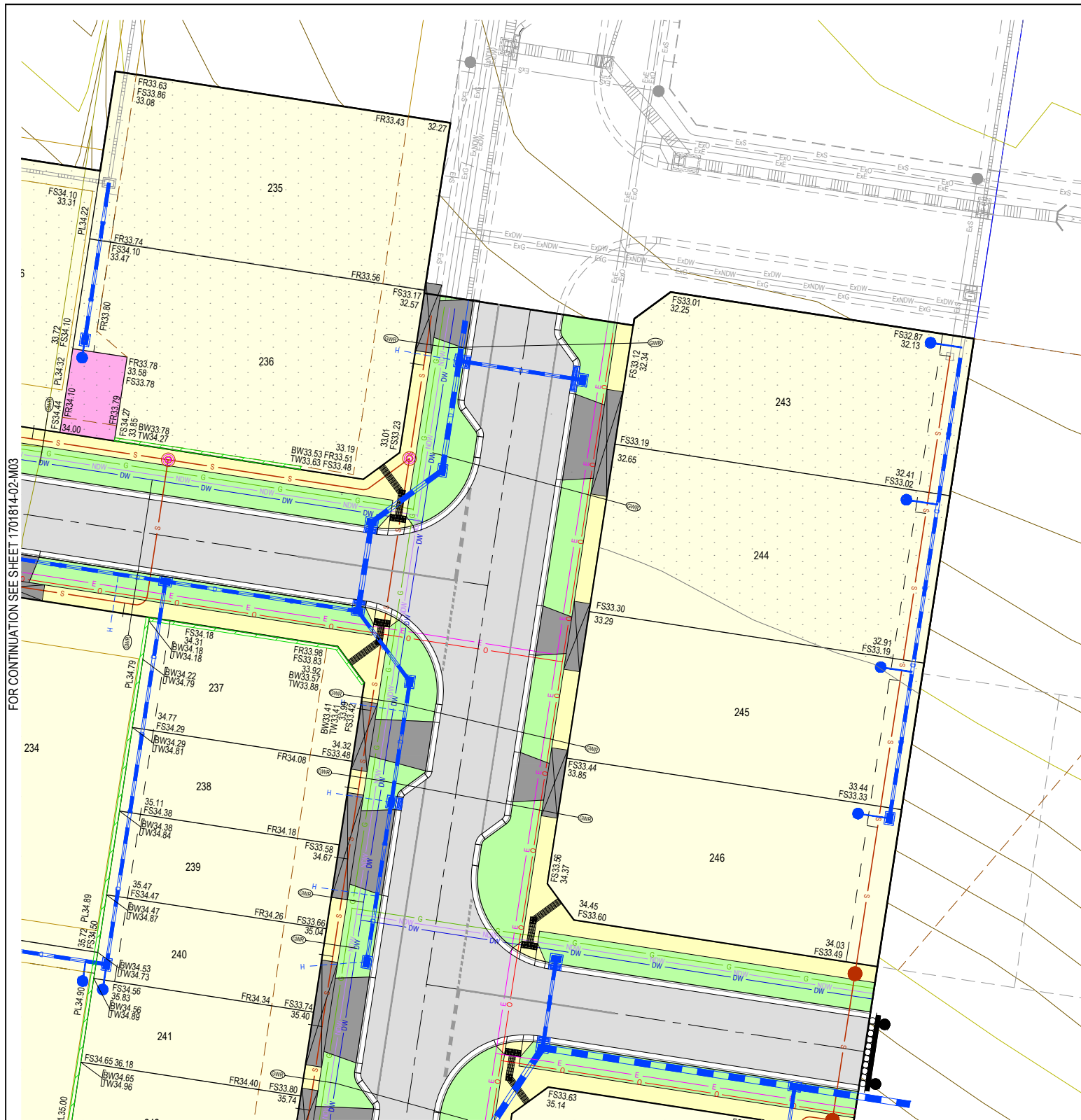

FOR CONTINUATION SEE ABOVE RIGHT

FOR CONTINUATION SEE SHEET 1701814-02-M03

FOR CONTINUATION SEE BELOW LEFT

LEGEND - MARKETING PLAN

STORMWATER DRAIN, PIT & PROPERTY INLET	EXISTING STORMWATER DRAIN	EXISTING SURFACE LEVEL
MELBOURNE WATER DRAIN & PIT	EXISTING SEWER	FINISHED BUILDING LINE LEVEL
SWALE DRAIN	EXISTING HOUSE DRAIN	FINISHED RIDGE LINE LEVEL
SEWER & MAINTENANCE STRUCTURES	EXISTING SWALE DRAIN	TOP OF RETAINING WALL
HOUSE DRAIN	ZERO LOT LINES	BOTTOM OF RETAINING WALL
SERVICE CONDUITS	RIDGE LINE	PAD DESIGN LEVELS
TACTILE PAVERS	DESIGN PADS	MASS ROCK RETAINING WALL
ELECTRICITY (UNDERGROUND)	DIRECTION OF FALL	CONCRETE SLEEPER RETAINING WALL
ELECTRICITY (OVERHEAD)	OVERLAND FLOW	STRUCTURAL FILL > 200mm DEEP
OPTIC FIBRE	ALLOTMENT TO BE GRADED EVENLY IN	LOT HATCHING
TELECOMMUNICATIONS	DIRECTION OF FALL TO LEVELS INDICATED	PAVEMENT HATCHING
GAS	CONCRETE EDGE STRIP WITH SUBSOIL DRAIN	NATURE STRIP HATCHING
WATER	"NO ROAD" SIGN & BARRIER	RESERVE HATCHING
RECYCLED WATER	PROPOSED DRIVEWAY	ELECTRICAL KIOSK HATCHING

© COPYRIGHT All rights reserved
Beveridge Williams & Co. Pty Ltd has granted a licence to the principle to use this document for its intended purpose.
No unauthorised copying is permitted

REV	DESCRIPTION	DATE	DRN.	APP.	REV	DESCRIPTION	DATE	DRN.	APP.
P2	AMENDED AS PER CLIENT'S REQUEST	25.07.22	YS	NM					
P1	AMENDED AS PER CLIENT'S REQUEST	22.07.22	YS	NM					
P0	ISSUED FOR INFORMATION	20.07.22	YS	NM					

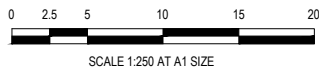

Designed
Date
N.MARTENS
01.01.2020
Drawn
L.SUTHERLAND
Approved
Date
N.MARTENS
20.07.22
PS Number
PS908410U

BW Beveridge Williams
1 Glenferrie Road
Malvern VIC 3144
ph: 03 9524 8888
www.beveridgewilliams.com.au

Project
Details
10 CANTY LANE, PAKENHAM
STAGE 02
CARDINIA SHIRE COUNCIL
Drawing
Title
MARKETING PLAN
(SHEET 4 OF 4)

PRELIMINARY PRINT
NOT FOR CONSTRUCTION

Sheet 04 of 04

Scale
1:250 @ A1

Project Ref
1701814
Stage No
02
Drawing No
M04
Rev
P2

